

MECHANICAL ENGINEERING
ELECTRICAL ENGINEERING
ENERGY CONSERVATION
STRUCTURAL ENGINEERING



INTRODUCTION

W. AND ASSOCIATES's group activities started in early 1965. Group activities were focusing on M&E engineering design services. In 1973, W. AND ASSOCIATES ROP. was then established to be consulting firm specializing in Mechanical, Plumbing, Sanitary, Electrical and Telecommunication .

During Thailand's booming economy, W. AND ASSOCIATES Consultants Co., Ltd. and W. AND ASSOCIATES Designs Co., Ltd. were established to cope with the fast-expanding real estate business. W. AND ASSOCIATES engineers had under taken responsibility of numerous projects for various engineering services, both design and construction supervision. Engineering services include electrical power, lighting, fire alarm system, security system, sound system, telephone system, telecommunication system, building automation system, air-conditioning system, ventilation system, smoke control system, vertical transportation, plumbing system, sanitary system, waste treatment system, computer site support system and other related systems for several major buildings and factories in Thailand.

Moreover, in 1996, W. AND ASSOCIATES has been one of companies approved by Department of Energy Development and Promotion (D.E.D.P.) for being registered as a consultant company in energy conservation program initiated by D.E.D.P. W. AND ASSOCIATES, as a registered consultant company, will be auditing the designated buildings and factories, which cover thousands buildings nationwide, to improve building's energy

In 2012 the group has begun the service in Civil/Structural Engineering discipline with all engineering disciplines included in one umbrella, the group now is focusing on providing one-stop, all-in-one engineering service for the client.

MESSAGE FROM PARTNERS

Our company is one of the earliest Thai owned consulting firms specializing in Building System (1965) / Civil and Structural Engineering Designs (2012). From the beginning, our company's philosophy has always been ethical practices with good and practical engineering designs. Our design principles for all of our projects are functionally advanced and economical designs meeting the present and future requirements of our clients, energy saving, ease of operation and maintenance. We will do our utmost to offer the designs which best serve our clients.

BOARD OF DIRECTORS



WICHAI LAKSANAKORN
Chairman / Co-Founder



WITHU RUKSVANICHPONG
Co-Founder



CHOKEWICHIT LAKSANAKORN
Managing Director

ENGINEERING SERVICES

CIVIL AND STRUCTURAL DESIGN

- 1.1 Structural work
- 1.2 Civil and Infrastructure work
- 1.3 Earthwork
- 1.4 Site Drainage
- 1.5 Investigation of Structural Integrity
- 1.6 Non-Destructive Structural Test

MEP DESIGN

2.1 ELECTRICAL SYSTEMS

- 2.1.1 Power
- 2.1.2 Lighting
- 2.1.3 Grounding
- 2.1.4 Emergency Power

2.2 TELECOMMUNICATION SYSTEM

- 2.2.1 Premise Distribution System
- 2.2.2 PABX
- 2.2.3 Telephone Wiring System
- 2.2.4 High Speed Data Cabling System

2.3 FIRE ALARM SYSTEM

2.4 SECURITY SYSTEM

- 2.4.1 Closed Circuit Television (CCTV)
- 2.4.2 Access Control
- 2.4.3 Burglar Alarm

2.5 AUDIO-VISUAL SYSTEM

- 2.5.1 Master Antenna Television system (MATV)

2.6 VERTICAL TRANSPORTATION SYSTEM

- 2.6.1 Elevators
- 2.6.2 Escalators

2.7 BUILDING AUTOMATION SYSTEM (BAS)

- 2.7.1 Energy Management
- 2.7.2 Comfort Control
- 2.7.3 Maintenance Management

2.8 SANITARY SYSTEM

- 2.8.1 Waste Water Treatment
- 2.8.2 Soil, Waste, Vent piping System
- 2.8.3 Site Drainage System

2.9 AIR CONDITIONING AND VENTILATING SYSTEMS

- 2.9.1 Exhaust and Ventilating System
- 2.9.2 Air-Conditioning System
- 2.9.3 Smoke Control System
- 2.9.4 Clean room System
- 2.9.5 Thermal Storage

2.10 PLUMBING SYSTEMS

- 2.10.1 Cold Water Distribution System
- 2.10.2 Hot Water Distribution System
- 2.10.3 Boiler Plant
- 2.10.4 Fire Extinguishing System
- 2.10.5 Sprinkler System
- 2.10.6 LPG Gas Piping System
- 2.10.7 Swimming Pool

PROJECT / CONSTRUCTION MANAGEMENT

- 3.1 Project / Construction Management
- 3.2 Site Supervision

OTHER SERVICES

4.1 ENERGY CONSERVATION

- 4.1.1 Auditing Designated Buildings and Factories as a Registered Consultant to Department of Energy Development and Promotion
 - Registration Number (Building Category) : 12
 - Registration Number (Factory Category) : 45
- 4.1.2 Energy Consumption Surveys in Building

4.2 VALUE APPRAISAL AND DUE DILIGENCE SERVICE



PROFESSIONAL RECORDS

HOTEL / RESORT

- 1.1 Banyan Tree Resort and Spa, Samui
- 1.2 W. Retreat and Residences, Samui
- 1.3 InterContinental Hua Hin
- 1.4 S31 Hotel
- 1.5 Mandarin Oriental Bangkok (the renovation)
- 1.6 Le Meridien Bangkok, Surawong
- 1.7 The Ambassador hotel (the renovation)
- 1.8 Holiday Inn Regent Beach Cha-Am
- 1.9 Holiday Inn Pattaya
- 1.10 Sheraton Grande Lagoon, Hua Hin
- 1.11 Hotel Plaza Athenes
- 1.12 Grand Hyatt Erawan Hotel
- 1.13 Westin Grande Sukhumvit (Renovation)
- 1.14 J.W. Marriott Hotel
- 1.15 Baiyoke 2 Sky Hotel
- 1.16 Swissotel (Le Concorde Complex)
- 1.17 Bangkok Peninsula Hotel (Now : Four Seasons Hotel)
- 1.18 The Fisherman's Village
- 1.19 Choengmorn Resort, Samui
- 1.20 Metropole Hotel, Phuket
- 1.21 Dusit Resort Hotel & Polo Club, Cha-Am
- 1.22 Chiangmai Holiday Inn (Green Hill) Hotel
- 1.23 Twin Lotus Hotel, Nakorn Srithamarat
- 1.24 Kempinski Hotel
- 1.25 Movenpic Hotel
- 1.26 Siam City Hotel
- 1.27 Swiss Garden Hotel
- 1.28 Bangkok Twin Tower Hotel
- 1.29 Bann Boran Chiangrai Hotel
- 1.30 Laguna Beach Club Resort
- 1.31 Siam Ballroom Phase 2 (Siam Intercontinental Hotel)
- 1.32 Royal Chiang Mai Hotel And Golf Club
- 1.33 Independence Hotel, Kampongsm, Cambodia (Renovation)
- 1.34 Little Duck Hotel, Chiangrai

OFFICES

- 2.1 Thanaphoom Tower
- 2.2 The Elephant Building, Ratchayothin
- 2.3 United Center Tower
- 2.4 Siripinyo Building
- 2.5 S.S.P. Building 3
- 2.6 C.T.I. Tower
- 2.7 Maleeonn Tower, Rama IV (including production house of channel 3 television)
- 2.8 Le Concorde Office Tower
- 2.9 Wall Street Tower
- 2.10 Srijuulp Tower
- 2.11 Beauty Gems Tower
- 2.12 Ural Building
- 2.13 Silpathai Building
- 2.14 The Nation Tower I, II
- 2.15 Thai Life Insurance Building, Rattanaibet
- 2.16 Muang Thong Thani Project (Villa Office)
- 2.17 The Malaysian Embassy
- 2.18 The Privy Council Office

CORPORATE OFFICES

- 3.1 Stock Exchange of Thailand (New Headquarters)
- 3.2 Thai Airways International Building, Head Office
- 3.3 Bank of Asia Head Office, Robot Building
- 3.4 Siam Commercial Bank (S.C.B.), Chidlom Office
- 3.5 Siam Commercial Bank (S.C.B.), Phase III, Ratchayothin
- 3.6 Shell Building, Head Office
- 3.7 Lean Tower, Thai Airways International
- 3.8 Samaggi Insurance Tower
- 3.9 Krung Thai Bank, Head Office
- 3.10 I.F.C.T. Buildings
- 3.11 ESSO Building

COMPLEXES

- 4.1 Jewelry Trade Center
- 4.2 Silom Complex
- 4.3 Royal Charoenkrung Tower
- 4.4 Central City Bangna (East Tower)
- 4.5 Ploenchit Center
- 4.6 Siam Commercial Complex (S.C.B.) Phase III
- 4.7 Amarin Plaza
- 4.8 Gems Tower
- 4.9 Laksi Plaza
- 4.10 Le Concorde Complex
- 4.11 Jomthien Complex
- 4.12 Bang-Rak Plaza
- 4.13 Palm Square, Phuket

GOVERNMENT

- 5.1 The Parliament Building, the office
- 5.2 Bank Note Printing Plant, Bank of Thailand
- 5.3 The Ministry Of Foreign Affairs Office, Jaengwattana
- 5.4 Metropolitan Electricity Authority office (MEA), Laksi
- 5.5 The United Nation Tower
- 5.6 Ministry of Finance Office, Rama VI
- 5.7 The United Nations, Economic and Social Commission for Asia and the Pacific (UN-ESCAP), the renovation
 - 5.7.1 Vertical Transportation
 - 5.7.2 HVAC upgrading system

RESIDENTIAL

- 6.1 Villa Asoke
- 6.2 Intro by RASA
- 6.3 Villa Rachatewi
- 6.4 The FAH
- 6.5 The Regent Bangkok
- 6.6 The SAIL Residences, Pattaya
- 6.7 Royal Charoenkrung Tower
- 6.8 Sky Beach
- 6.9 Silom Palace
- 6.10 Silver Beach
- 6.11 Lumpini Park View
- 6.12 Park Beach
- 6.13 City Lake Condominium
- 6.14 La Cascade
- 6.15 The President Park
- 6.16 Sathorn Park Place
- 6.17 Dusit Resort, Hua Hin
- 6.18 Metro Jomthien Condotel
- 6.19 Tridhos City Marina
- 6.20 Bangkok River Park Condominium
- 6.21 Thana City
- 6.22 Apartment Sukhumvit 33
- 6.23 HuaHin Sea-View Paradise
- 6.24 Bann Monchale, Cha-Am
- 6.25 Sathorn Garden
- 6.26 The Elephant Building, Ratchayothin
- 6.27 Central City Bangna (East Tower)
- 6.28 Coconut Beach Condominium, Pattaya

RETAILS

- 7.1 Central Plaza Chiang-Rai
- 7.2 Central Plaza Pinklao (the renovation)
- 7.3 The Vue, Charoen Nakorn
- 7.4 The Rain Hill sukhumvit 47
- 7.5 Nikorn Thani
- 7.6 Porto Chino Community mall
- 7.7 Digital Gateway, Siam Square (Independent Checker)
- 7.8 B/G C Super Center
 - 7.8.1 Thanyaburi Branch
 - 7.8.2 Mahachai Branch
 - 7.8.3 Loomsak Branch
 - 7.8.4 Ta-ma-ka, Kanjanaburi Branch
 - 7.8.5 Rajapruck Branch
 - 7.8.6 Thepkasastree
- 7.9 Central Town Center (Rattanaibet Phase II)
- 7.10 the Erawan Bangkok
- 7.11 Central Department Store, Hua-Mark
- 7.12 Robinson Department Store, Donmuang
- 7.13 Ploenchit Center
- 7.14 Laksi Plaza
- 7.15 Bangrak Plaza
- 7.16 Silom Complex
- 7.17 Amarin Plaza
- 7.18 Cathay Department Store, Bang Kae
- 7.19 Ratchadamri Arcade
- 7.20 Ploenchit Arcade

EDUCATION

- 8.1 IT and Laboratory Studies for medical student, Siriraj Hospital
- 8.2 Laboratories Study and Bio Safety research facilities, Khon Kaen University
- 8.3 Thammasat Gymnasium, The 13th Asian Game Project
- 8.4 Thammasat Multipurpose Building II, Bangkok
- 8.5 Medical Study building for Dentist, Khon Kaen University
- 8.6 Bangkok University art gallery and multipurpose building
- 8.7 Mae-Fah Luang University, Chiang-Rai
- 8.8 Khon Kaen University, Exhibition And Conference Building
- 8.9 Thammasat Central Library, Bangkok
 - 8.9.1 Lecture Building I
 - 8.9.2 Lecture Building II
 - 8.9.3 Lecture Building III
 - 8.9.4 Lecture Building IV
 - 8.9.5 Faculty of Engineering Building (Int.)
 - 8.9.6 Library Building
 - 8.9.7 Laboratories
 - 8.9.8 Multi - Purpose Building
- 8.10 Na-Ray Suan University, Pichit

INDUSTRIALS

- 9.1 Yuasa Battery Factory, Gateway Industrial Estate
- 9.2 Siam Nastech Factory (Extension)
- 9.3 Fuji Serina Factory
- 9.4 Cornel Polymer Factory
- 9.5 Siamwala Warehouse
- 9.6 Super Gold Factory
- 9.7 Universal Toy Factory (Match Box)
- 9.8 Pranda Jewelry Factory
- 9.9 Artico Craft Toy Factory
- 9.10 Match Box Factory
- 9.11 American Standard Factory, 2nd Phase
- 9.12 Tai Ping Factory, 2nd Phase
- 9.13 Coca-Cola Bottling Plants (Hua Mak, Pathumthani, Khon Kaen, Lampang, Haad Yai)
- 9.14 Bangkok Domtex
- 9.15 NTS Steelmill
- 9.16 Bangkok Weaving Mill
- 9.17 Siam Tsuchiya Factory
- 9.18 Cheena Gasket Factory
- 9.19 Siam Tsuchiya Mfg. Factory, Bangplee

COMPUTER CENTERS

- 10.1 North Park Computer Center, Stock Exchange of Thailand
- 10.2 United Nations Computer Center, Bangkok, 1972
- 10.3 Sita Switching Center, Rajdamri Arcade, 1979
- 10.4 Computer Center At Bank Note Printing Plant, Bank Of Thailand, 1977
- 10.5 Computer Center, Siam Commercial Bank, Chidlom Office
- 10.6 Computer Center, Krung Thai Bank Head Office
- 10.7 Computer Center 1st Expansion, Siam Commercial Bank, Chidlom Office
- 10.8 Northern Computer Center, Siam Commercial Bank, Chieng Mai
- 10.9 Computer Center 2nd Expansion, Siam Commercial Bank, Chidlom Office
- 10.10 Southern Computer Center, Siam Commercial Bank, Had Yai
- 10.11 Siamnet Computer Center
- 10.12 Government Saving Bank Computer Centers at Bangkok, Chiangmai, Nakornraisima
- 10.13 ESSO's Computer Center (new), Bangkok
- 10.14 Renovations of UPS for Siam Commercial Bank Computer Center
- 10.15 Data Center, Thai Airways International

HEALTH CARES

- 11.1 Srinakarin Hospital (Srinakarin University)
- 11.2 Ratnin Eye Hospital
- 11.3 Khon Kaen Hospital
- 11.4 Buayai Hospital
- 11.5 Siriraj Hospital, Anantamahidhol Building
- 11.6 Bumrungraj Hospital, Main Power Distribution (Renovation)
- 11.7 Khelangnakorn Hospital, Lampang
- 11.8 Kalasin Hospital

PORTS

- 12.1 Sriracha Harbour
- 12.2 Maptaphut Port
- 12.3 Phuket Deep Sea Port
- 12.4 Songkla Deep Sea Port
- 12.5 Donmuang Airport (Air-Bridge Terminals)

MASTER PLAN, INFRASTRUCTURE PROJECT

- 13.1 Mass Rapid Transport Authority (MRTA) (CSC I)
- 13.2 Mae-Fah Luang University, Chiang-Rai
- 13.3 The Master Plan For National Housing Authority, Din-Daeng Site
- 13.4 Muang Thong Thani, Infrastructure
- 13.5 Telephone Organization Of Thailand, Ploenchit Office
- 13.6 State Railway Of Thailand
 - 13.6.1 Paholyothin Site
 - 13.6.2 Makkasan Site
- 13.7 The Government House

LABORATORY

- 14.1 Siriraj Hospital, IT Studies and Laboratory for Medical studies
- 14.2 Khon Kaen University Laboratory for Medical studies

OTHER PROJECTS

- 15.1 Community Market, Phnom Penh, Cambodia (Soraya Market)
- 15.2 New Office, Storage and Garage of ESSO Standard Thailand Limited, Bangkok
- 15.3 ESSO's Chongnonsri Terminal Security System And Command Center
- 15.4 Multi-Credit Corporation of Thailand Company Limited (Kanchanat Building Branch)
- 15.5 Thanmasat Gymnasium, The 13th Asian Game
- 15.6 Mae-Ping Convention (Imperial Mae-Ping Hotel)

ENERGY CONSERVATION PROJECT

- 16.1 Hawaii Tower, Bangkok
- 16.2 TOT services center, Maptapud, Rayong
- 16.3 Song Phunburi Hotel, Suphanburi
- 16.4 Petcharat Hospital, Petchburi
- 16.5 Saovaluk Thani Hotel, Surat Thani
- 16.6 Rajabhat Buriram, Buriram
- 16.7 Amarin Plaza, Bangkok
- 16.8 Sukhumvit Hospital
- 16.9 AP National, Samut Prakarn
- 16.10 Samaggi Insurance, Bangkok
- 16.11 Laksi Plaza, Bangkok
- 16.12 Riverside Hotel, Bangkok
- 16.13 Saint John University, Bangkok
- 16.14 Saint John Polytechnic, Bangkok
- 16.15 Saint John School, Bangkok
- 16.16 Saint John International School, Bangkok
- 16.17 BB Building, Bangkok
- 16.18 Pachorn Place, Bangkok
- 16.19 Pacific Price Hotel, Chonburi
- 16.20 Welcome Jomthien Hotel, Chonburi
- 16.21 Talay Thong Tower, Chonburi
- 16.22 Rom-Po Mansion, Bangkok
- 16.23 Jarun Tower, Bangkok
- 16.24 Bang Pa Kong Royal Country Club, Cha Choeng Sao
- 16.25 UN-ESCAP building, Bangkok



W. AND ASSOCIATES



PROJECT REFERENCE

MASTER PLAN





PROJECT REFERENCE

- STATE RAILWAY OF THAILAND The Master Plan for Land
- MAE-FAH LUANG UNIVERSITY
- PRIVY COUNCIL OFFICE สำนักงานเลขาธิการองคมนตรี
- BAAN MANANGKASILA
- THE GOVERNMENT HOUSE
- NATIONAL HOUSING AUTHORITY DIN DAENG SITE
(Construction Phase)
- RATCHADAMNOEN



PROJECT REFERENCE

Phaholyothin Site

Makkasan Site



Master plan

Project Title : **STATE RAILWAY OF THAILAND**
The Master Plan for Land Use

Location : Phaholyothin – 2,000 Rais
 Makkasan - 300 Rais

Owner : State Railway of Thailand

Commissioned : 1998

Project Summary : The site includes Transportation Hub,
 Hotel, Convention Center, Residential,
 School and Commercial Buildings.
District Cooling and Utilities Tunnel is introduced.



Project Title : **MAE-FAH LUANG UNIVERSITY**

Location : Chiang Rai

Owner : Ministry of Education

Commissioned : 1997 - 2002

Project Summary : 2,000 rais of Education Complexes comprises of Education Centers,
 Library, Dormitories and etc.Total Construction areas: 180,000 sq.m.
 Total Construction Cost: 2,500 Millions B.

Firm's Role : Infrastructures – Design of Waste Water Treatment Plants,
 Water Supply Generation and Distribution System for the whole site.
 Education Complexes – Design of building system including Air conditionings,
 Ventilating, Electrical Power, Lightings, Telecommunications, Fire Alarm,
 Fire Fighting, Plumbing and Lightning Protection systems.



PROJECT REFERENCE

Master plan



- Project Title : **PRIVY COUNCIL OFFICE**
สำนักงานเลขาธิการรองคมนตรี
- Location : Saranrom Palace, Bangkok.
- Owner : The Office of His Majesty's Principal Private Secretary
- Commissioned : 2004
- Project Summary : 8,000 Sq.m. 3-Stories Building. 7,000 sq.m. of office area.
- Firm's Role : M&E System Design: Air-conditioning, Ventilating, Electrical Power, Lighting, Telecommunication, Fire Alarm, Vertical Transportation, Plumbing, Fire Fighting and Sanitary System.



- Project Title : **BAAN MANANGKASILA**
- Location : Bangkok.
- Owner : The office of the Prime Minister
- Commissioned : 2005
- Project Summary : 8,000 Sq.m. 3-Stories Building.
- Firm's Role : M&E System Design: Air-conditioning, Ventilating, Electrical Power, Lighting, Telecommunication, Fire Alarm, Vertical Transportation, Plumbing, Fire Fighting and Sanitary System.



PROJECT REFERENCE

Master plan

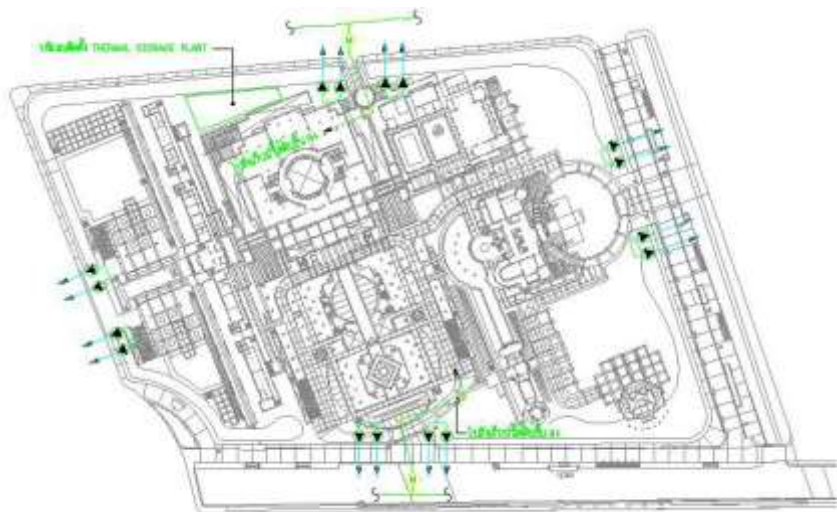

Project Title : **THE GOVERNMENT HOUSE**

Location : Phitsanu Lok Road, Bangkok.

Owner : The office of Prime Minister

Commissioned : 1998

Firm's Role : Study of Infrastructure and Land Use.
Outline for Mechanical, Electrical and other Utilities Systems.
District Cooling and Utilities Tunnel is introduced.

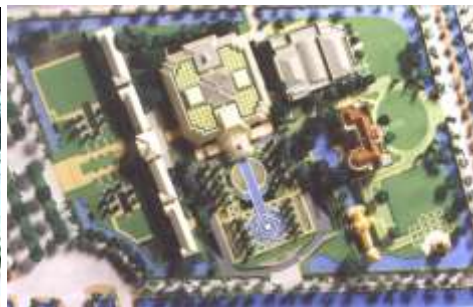

PROJECT REFERENCE

Master plan

SITE A



SITE B



SITE C



- Project Title : **NATIONAL HOUSING AUTHORITY
DIN DAENG SITE (Construction Phase)**
- Location : Din Daeng, Bangkok.
- Owner : National Housing Authority (NHA)
- Project Summary : Site A: 720 units
Site B: 320 units
Site C: 1,200 units
- Firm's Role : M&E System Design: Air-conditioning, Ventilating, Electrical Power, Lighting, Telecommunication, Fire Alarm, Vertical Transportation, Plumbing, Fire Protection and Sanitary System.



PROJECT REFERENCE

Master plan

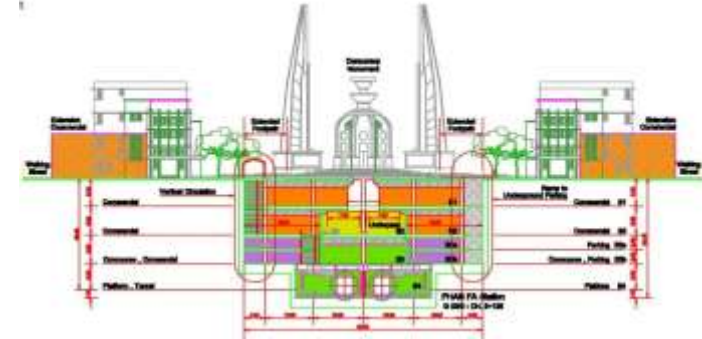
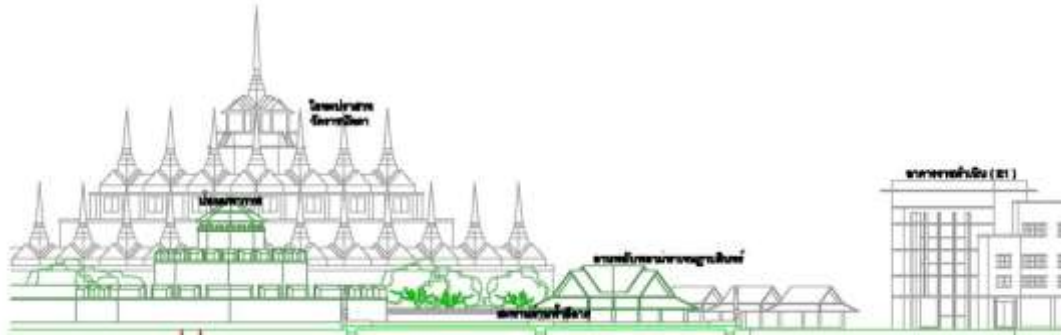

- Project Title : **RATCHADAMNOEN**
- Location : Ratchadamnoen Rd., Bangkok
- Owner : The Crown Property Bureau
- Commissioned : 2002
- Project Summary : The site includes Transportation Hub, Residential, School and Commercial Buildings.
- Firm's Role : Outline for Improving of Infrastructure and Utilities for area scope of work





W. AND ASSOCIATES



PAST PROJECTS



PAST EXPERIENCE

Hotels



W. RETREAT, SAMUI
- M.E.P. -



BANYAN TREE, SAMUI
- M.E.P. -



INTERCONTINENTAL HUA HIN
- M.E.P. -



SHERATON GRANDE LAGOON HUA HIN
- M.E.P. -



LAGUNA BEACH RESORT
(Part of LAGUNA Phuket)
- M.E.P. -

M = Mechanical E = Electrical P = Plumbing



PAST EXPERIENCE

Hotels



DOUBLE TREE by HILTON
M,E,P



MODE SATHORN HOTEL
M,E,P



HILTON SUKHUMVIT BANGKOK
M,E,P



MARIOTT RAYONG
M,E,P

M = Mechanical E = Electrical P = Plumbing



PAST EXPERIENCE

Hotels



BAIYOKE SKY HOTEL
Currently the tallest building in Thailand
- M.E.P. -



GRAND HYATT ERAWAN HOTEL
- M.E. -



TWIN LOTUS HOTEL
- M.E.P. -



HOLIDAY INN CHIANG MAI
- M.E.P. -



WESTIN GRANDE SUKHUMVIT
- M. -



SIAM CITY HOTEL
- M.E. -



INDEPENDENCE HOTEL CAMBODIA
- M.E.P. -



FOUR SEASONS HOTEL
- M.E. -



J.W. MARRIOTT HOTEL
(Ploenchit Center)
- M. -



SOL TWIN TOWERS
- M.E. -



METROPOLE HOTEL, PHUKET
- M.E.P. -

M = Mechanical E = Electrical P = Plumbing



PAST EXPERIENCE

Hotels



MANDARIN ORIENTAL The Renovation
Back of House, Main Lobby



HOLIDAY INN PATTAYA
- M.E.P. -



S31 HOTEL
- M.E.P. -



HOTEL PLAZA ATHENEES
- M.E.P. -



LE MERIDIEN BANGKOK
- M.E.P. -



MERCURE AMBASSADOR HOTEL
(Renovation)
- M.E.P. -



HOLIDAY INN REGENT BEACH CHA-AM (Renovation)
- M.E.P. -



FISHERMAN'S VILLAGE
- E. -



DUSIT AND RESORT HOTEL
- M.E.P. -



SHERATON GRAND LAGOON
(Rebranded to ANGSANA)



SALA-SAMUI RESORTS
- M.E.P. -



BAAN BORAN CHIANG SAEN
(ANANTARA GOLDEN TRIANGLE)

M = Mechanical E = Electrical P = Plumbing



PAST EXPERIENCE

Residential



SILVER BEACH CONDOMINIUM
- E -



CITY LAKE CONDOMINIUM
- M.E. -



LA CASCADE
- E -



SATHORN GARDEN
- M -



ROYAL CHAROENKRUNG
- M.E. -

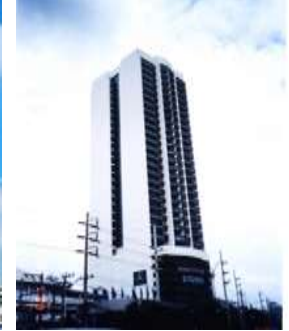

LUMPINI PARK VIEW
- M.E.P. -



PARK BEACH CONDOMINIUM
- E -



SKY BEACH CONDOMINIUM
- E -



JOMTIEN COMPLEX
- E -



CENTRAL BANGNA (East Tower)
- M.E.P. -



COCONUT BEACH CONDOMINIUM
- M.E.P. -



THE PRESIDENT PARK
- M.E. -

M = Mechanical E = Electrical P = Plumbing



PAST EXPERIENCE

Residential



SATHORN PARK PLACE
- M.E.P -



TRIDHOS CITY MARINA
- M.E.P -



INTRO BY RASA Condominium
- M.E.P -



BANGKOK RIVER PARK
- M.E.P -



VILLA RACHATEWI
- M.E.P -



METRO JOMTIEN CONDOTEL
- M.E.P -



PARKLAND PHASE II
- M.E.P -



THANA CITY



BAAN MON-CHALE
- M.E.P -

M = Mechanical E = Electrical P = Plumbing



PAST EXPERIENCE

Residential



MODE SUKHUMVIT 61
-M,E,P-



VILLA ASOKE
-M,E,P-



VERTIQ CONDOMINIUM
-M,E,P-



VIA BOTANI
-M,E,P-



URBANO SATHORN
-M,E,P-



THE AXIS CONDOMINIUM
-M,E,P-



KHAO-YAI RESIDENCE
-M,E,P-

M = Mechanical E = Electrical P = Plumbing





PAST EXPERIENCE

Offices



MALEENOND TOWER
(Channel 3 TV Studio)
- M,E,P -



ESSO BUILDING



GRAND AMARIN TOWER
- M,E,P -



UNITED CENTER
- M,E -



C.T.I TOWER
- M,E -

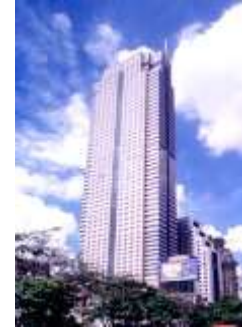

JEWELRY TRADE CENTER
- M,E,P -



S.S.P TOWER III
- M,E,P -



SRIJULSUP TOWER
- M,E -



THE NATION TOWER I, II
- M -



SIRIPINYO BUILDING
- M,E -



WALL STREET TOWER
- M,E -



GEMS TOWER
- M,E,P -

M = Mechanical E = Electrical P = Plumbing



PAST EXPERIENCE

Offices



ELEPHANT BUILDING
- M,E,P -



BEAUTY GEMS BUILDING
- M,E -



VILLA OFFICE
- M,E,P -



MALAYSIAN EMBASSY
- M -



THAI LIFE INSURANCE



MINISTRY OF FINANCE
- E -



MINISTRY OF FOREIGN AFFAIR
- M -



UNITED NATIONS - ESCAP
- M,E -



BANK NOTE PRINTING
- M,E -



METROPOLITAN ELECTRICITY
AUTHORITY, BANGKOK
- M -



PRIVY COUNCIL OFFICE
- M,E,P -



LECONCORDE COMPLEX
- M,E,P -



PARLIAMENT BUILDING (OFFICE)
- M,E,P -

M = Mechanical E = Electrical P = Plumbing



PAST EXPERIENCE

Corporate Offices



SIAM COMMERCIAL COMPLEX (PHASE III)
- M.E.P. -



SIAM COMMERCIAL BANK
(Old Head Quarter)



THAI AIRWAY INTERNATIONAL (Head Quarter)
- M.E. -



SHELL HEAD OFFICE
- M -



SAMAGGI TOWER
- M.E.P. -



BANK OF ASIA
(Head Quarter)
- M -



KRUNGTHAI BANK
(Head Quarter)
- M.E. -



IFCT BUILDING
- M.E. -

M = Mechanical E = Electrical P = Plumbing



PAST EXPERIENCE

Retails



CENTRAL PLAZA CHIANG-RAI
- M.E.P. -



ASIATIQUE the river front
- M.E.P. -



RAIN HILL
- M.E.P. -



THE VUE
- M.E.P. -



PORTO CHINO
- M.E.P. -



BIG C Super Center
- M.E.P. -



CENTRAL TOWN CENTER RATTANATHIBET
- M.E.P. -



CENTRAL PLAZA SURATTHANI
- M.E.P. -



CENTRAL PLAZA PINKLAO (The Renovation)
- M.E.P. -

M = Mechanical E = Electrical P = Plumbing



PAST EXPERIENCE

Retails



AMARIN PLAZA
-M.E.-



BANGRAK PLAZA
-M-



THE ERAWAN BANGKOK
-M.E.P.-



SILOM COMPLEX
-E.P.-



RAJADAMRI ARCADE
-M.E.-



SORAYA SHOPPING, PHNOM PENH
-M.E.P.-



GOLDEN CITY SHOPPING CENTER
PHNOM PENH



LAKSI PLAZA
-M.E.-

M = Mechanical E = Electrical P = Plumbing



PAST EXPERIENCE

Health Cares



SRINAKARIN HOSPITAL
-M,E,P-



KHONKAEN HOSPITAL
-M,E,P-



BUA YAI HOSPITAL
-M,E,P-



RATNIN EYE HOSPITAL
-M,E,P-



KALASIN HOSPITAL
-M,E,P-



BLOOD CENTER
THAI RED CROSS SOCIETY
-M,E,P-



SIRIRAJ HOSPITAL
Laboratory and IT studies for medical student
-M,E,P-

M = Mechanical E = Electrical P = Plumbing



PAST EXPERIENCE

Health Cares



PATANA MEDICAL CENTER
-M,E,P-



SONGLANAKARIN HOSPITAL
-M,E,P-

M = Mechanical E = Electrical P = Plumbing



PAST EXPERIENCE

Educations / Gym / Master plan



THAMMASAT UNIVERSITY
(Rangsit Campus)
- Main Admission Office Building
- Lecture Building I
- Lecture Building III
- Lecture Building IV
- Faculty of Engineering Building (Int.)
- Library Building (Bangkok campus)
- Laboratories
- Multi-Purpose Building (Bangkok campus)



MAEFAH-LUANG UNIVERSITY
Education Buildings
- M.E.P -



Phaholyothin Site



Makkasan Site



AUDITORIUM
Khon Khaen University
- M.E -



THAMMASAT UNIVERSITY LIBRARY
- M -



BANGKOK UNIVERSITY ART GALLERY
- M.E.P -

STATE RAILWAY OF THAILAND
The Master Plan for Land Use



GYMNESIUM, 13th ASIAN GAME
- M -



HUAMARK STADIUM
- E -

M = Mechanical E = Electrical P = Plumbing

